

SPECIFICATION
COMMERCIALY AVAILABLE

ITEM: CERAMIC DUPLEXER
 PART NUMBER: CFD-077208554
 RoHS

ISSUED / REVISION	ENGINEER APPROVED	DOCUMENT CHECKED	DRAFTSMAN
07/09/2019 ^(ASM)			

FILTRONETICS Inc

1. Application

THIS SPECIFICATION APPLIES TO A BAND PASS DUPLEX FILTER USING DIELECTRIC RESONATORS.

2. Part Number: CFD-077208554

3. Electrical Specifications:

Parameter	Unit	Specification	
		Low Band	High Band
Center Frequency	MHz	772.5	855.5
Bandwidth	MHz	7 Min	9 Min
Insertion Loss in BW	dB	3.2 Max	
Ripple in BW	dB	0.5 Max	
Return Loss in BW	dB	15 Min	
Attenuation	-	50 dB Min @ 100~628 MHz	50 dB Min @ 100~723 MHz
		25 dB Min @ 628~741 MHz	30 dB Min @ 794~824 MHz
		3 dB Min @ 741~763 MHz	40 dB Min @ 762~776 MHz
		15 dB Min @ 792~825 MHz	5 dB Min @ 870~886 MHz
		40 dB Min @ 851~870 MHz	17 dB Min @ 886~905 MHz
		50 dB Min @ 910~1500 MHz	46 dB Min @ 941~1500 MHz
IN/OUT Impedance	Ω	50	
Input Power	Watt	1 Max	
Operating Temperature	°C	-30 ~ +80	

4. Mechanical Package:

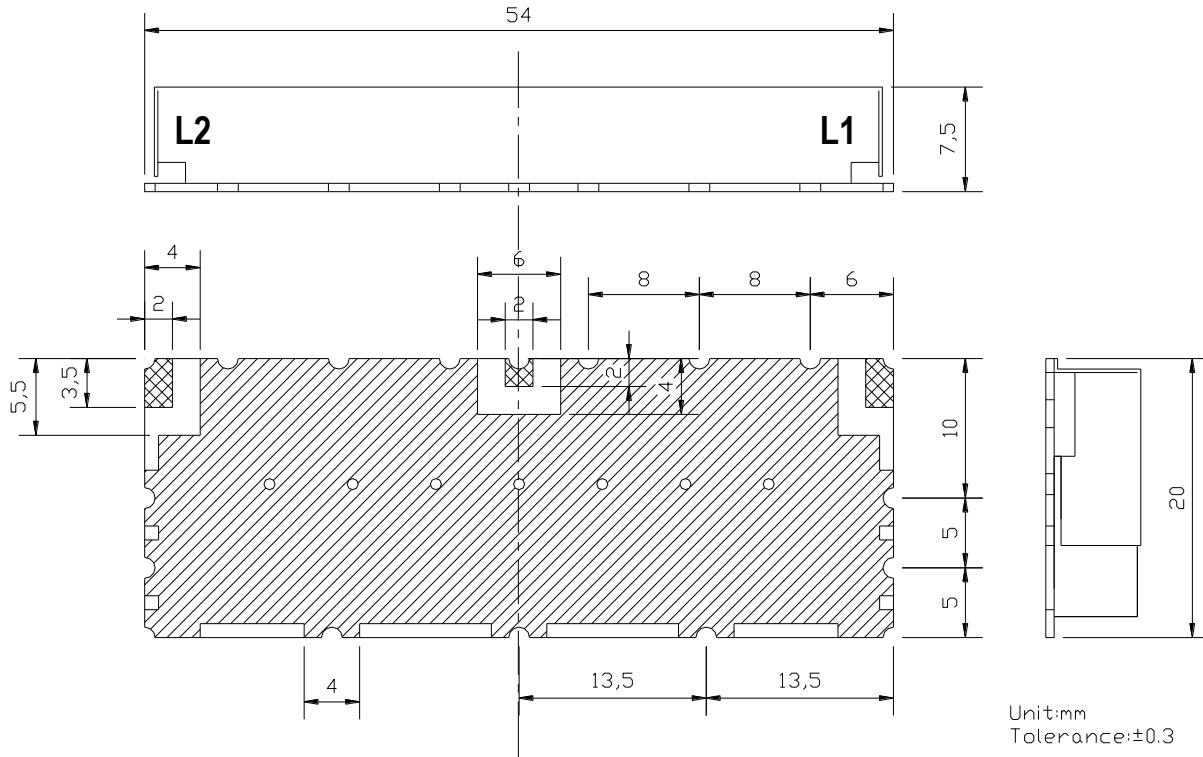

● CAUTIONS:

1. When handling products, be careful not to damage the outer-electrode.
2. When handling products be careful not to touch the outer-electrode with bare hands or solder-ability is reduced.
3. Do not apply excessive pressure or shock to product in handling or in transportation or damage to the ceramic filters may result.

5. Definitions

TERMS	DESCRIPTION	SPECIFICATION
Center Frequency	The midpoint of through band pass filter pass band, normally expressed as the arithmetic mean of the -3db point. Also called fo.	3. SPECIFICATION
Pass Band Width	The width of the pass band of a filter referenced to the minimum insertion loss point in the pass band. The pass band of a filter is stated as -1.0dB bandwidth.	
Insertion Loss	The loss of the filter, in db, measured at center frequency relative to a through line (0 dB).	
Attenuation	Reduction of RF power through a filter measured in dB, at desired band and referenced to 0 dB. (Filter to be removed from circuit)	
Pass Band Ripple	Variations in loss in the pass band of the filter, superimposed upon the fundamental shape of the pass band.	
V.S.W.R in Pass Band	The ratio of the maximum value of a standing wave to its minimum value, related to the return loss in pass band.	

6. Reliability Test and Conditions

ITEM	TEST CONDITIONS	REQUIREMENTS
Resistance to solder heat	Preheat temperature : 120 to 150°C Preheat time: 1 to 1.5 min Solder temperature: 260 +/- 10°C Dipping time: 10 +/- 0.5 sec	No damage such as cracks should be caused in chip element.
Solderability	Preheat temperature: 120 to 150°C Preheat time: 1 to 1.5 min Solder temperature: 235 +/- 5°C Dipping time: 5 +/- 1 sec	More than 80% of the terminal electrode shall be covered with new solder
Heat resistance (High-temperature Load)	Temperature: 85 +/- 2°C Applied voltage: Rated voltage Applied current: Rated current Recovery: 1 to 2hrs of recovery under the standard condition after the removal from test chamber.	No mechanical damage. After test, the device shall satisfy the specification in section 3.
Thermal shock (Temperature cycle)	Conditions for 1 cycle Step 1: + 85°C 15 min Step 2 : - 30°C 15 min Number of cycle: 10	No mechanical damage. After test, the device shall satisfy the specification in section 3.
Humidity Resistance	Temperature: 40 +/- 2°C Humidity: 90 to 95% RH Duration: 96 +/- 5 hrs Recovery: 1 to 2hrs of recovery under the standard condition after the removal from test chamber.	No mechanical damage. After test, the device shall satisfy the specification in section 3.
Vibration	Frequency: 10 ~ 50 Hz Amplitude: 1.52 mm (0.060 inches) Direction: X, Y and Z Time: each 30 min for all directions	No mechanical damage. After test, the device shall satisfy the specification in section 3.

7. REFLOW SOLDERING STANDARD CONDITIONS

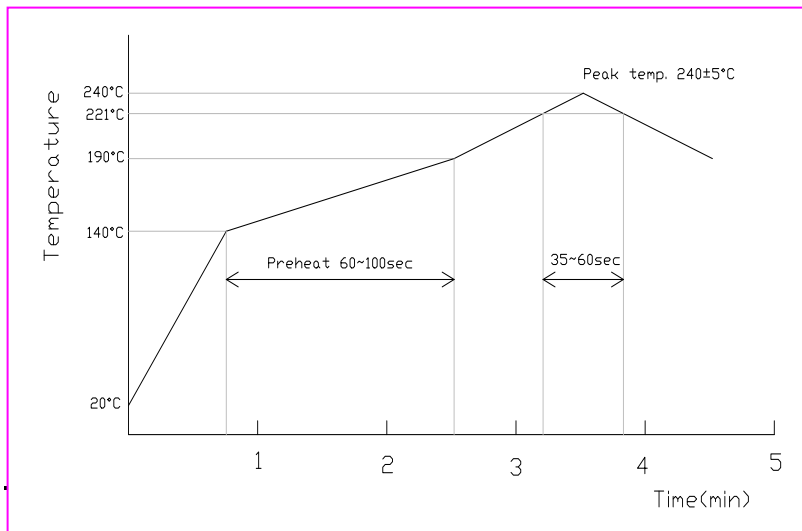

- Measuring point of temperature in-out terminals of the device.
- Reflow Soldering
- Both convection and infrared rays
- Hot air
- Solder Cream: Sn96.5/Ag3.5

FILTRONETICS, Inc

(p) 816-231-7375 (f) 816-241-0368

www.filtro.net

Form-078 2/7/2012