

FN-1994W

LOW PASS FILTER

0.2 dB CUTOFF: 400.0 MHz
 VSWR to 400 MHz: 1.5 to 1
 IMPEDANCE : 50 OHMS (IN & OUT)
 RIPPLE: 0.2 dB MAX
 20 dB STOPBAND: 580 MHz to 800 MHz
 40 dB STOPBAND: 800 MHz to 1.2 GHz
 OPERATING TEMPERATURE : -20°C to +85°C
 OPERATIONAL POWER : 200 WATTS MAX

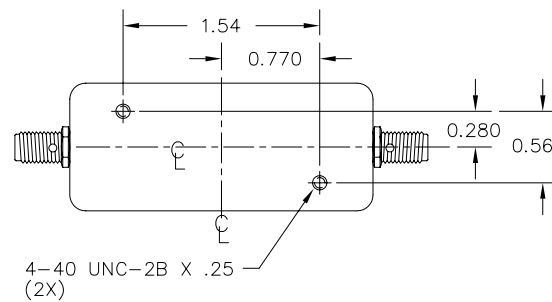
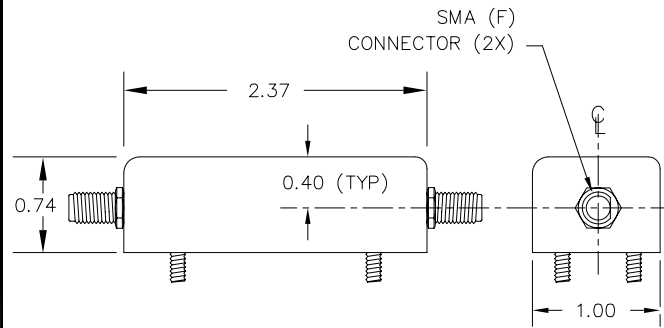

FN-1994WF

FN-1994W DRAWING SUMMARY

FILTRONETICS, INC.
 6010 PARRETTA DR.
 KANSAS CITY, MO 64120
 816-231-7375
 FAX 816-241-0368
 WWW.FILTRO.NET

TOLERANCES UNLESS NOTED

.XX = ± .020
 .XXX = ± .010

ANGLE = ± 1°
 HOLES = ± .002

REVISED 9/22/03

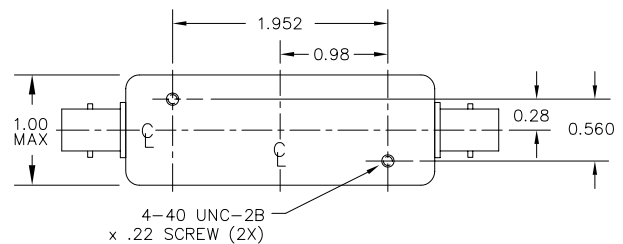
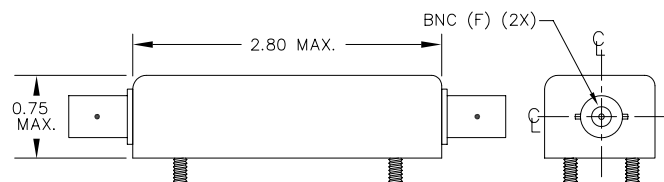

FN-1994WJJ